

Six Terminal Relay

1) Incoming Power

- a) One hot to L1
- b) One hot to L2
- c) Ground to ground

2) Limit Switch

- a) cut ground off,
Don't use!
- b) Cut connector from pigtail
- c) Connect one limit switch lead to one of the pigtail leads
- d) Connect one limit switch lead to one of the pigtail leads

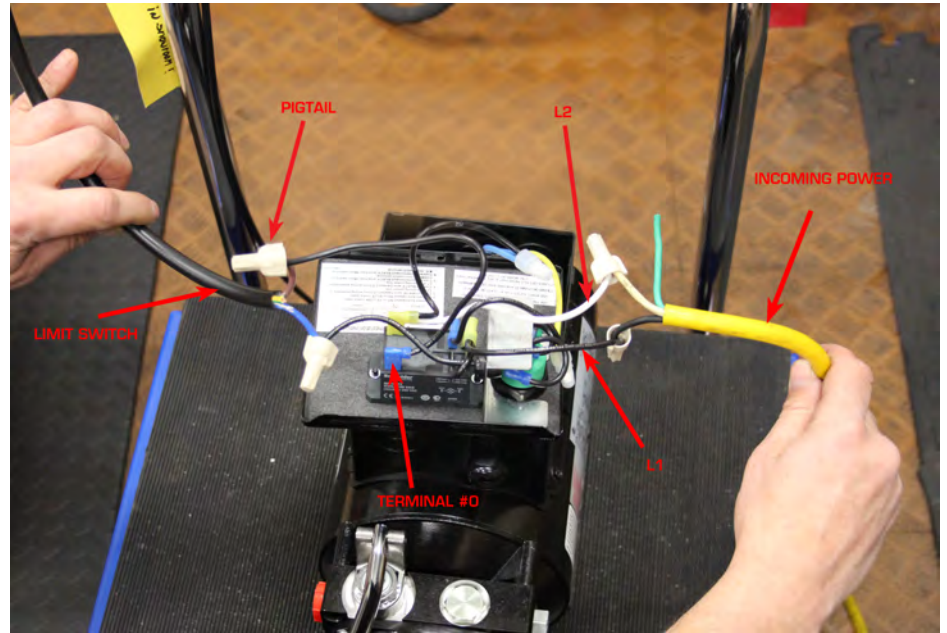
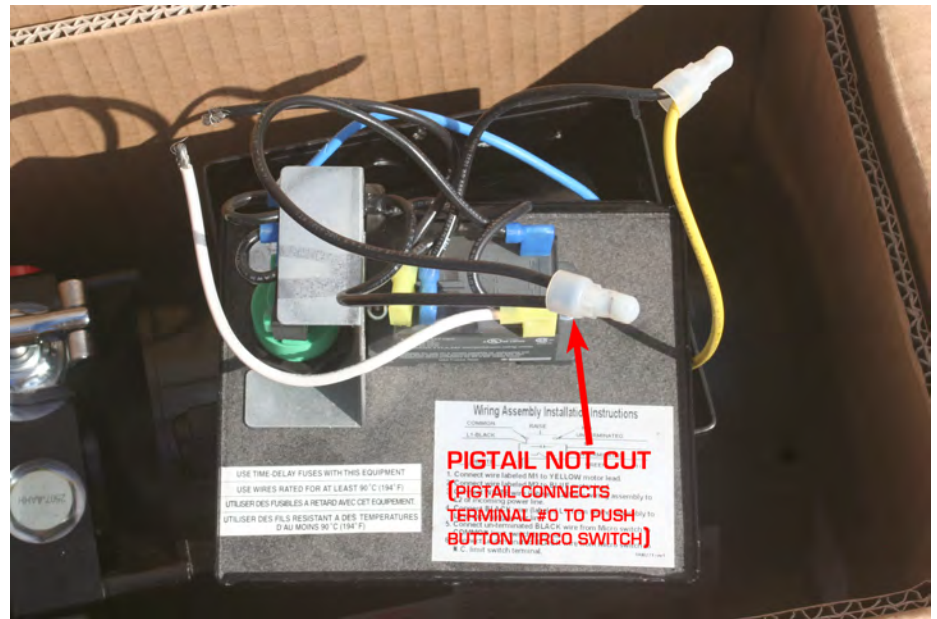

*In Case Of No Pigtail

- a) Cut wire from terminal #0 to the mirco switch
- b) Connect limit switch leads as if it was the pig tail

